

**Spezialfittings – Special fittings – Raccords spéciaux
Übergangsstücke – Adapters – Adaptateurs**

max. 2000 bar
max 29 000 PSI

Fittings in korrosionsbeständigen Werkstoffen

- Hochdruckfittings und Übergangsstücke mit mediuüberührtem Einsatz in korrosionsbeständigen Werkstoffen.
- In der bewährten SITEC-Schrumpfkonstruktion sichert der Einsatz aus dem gewählten Werkstoff die Korrosionsbeständigkeit und der hochfeste Körper in W.-Nr. 1.4571 die Druckfestigkeit der Einheit.
- Relativ weiche, aber äusserst korrosionsbeständige Werkstoffe können dank dieser Schrumpfkonstruktion auch bei hohen Drücken eingesetzt werden.
- Werkstoffe der Einsätze:
Hastelloy C4 – Hastelloy C276 – Hastelloy C22 – Monel – Titan – Inconel.
- Weitere Werkstoffe auf Anfrage.
- Fittings in korrosionsbeständigen Werkstoffen sind entsprechend den Katalogblättern 720.01–720.06 erhältlich.
- Zur Bezeichnung von Fittings in korrosionsbeständigen Werkstoffen wird die Artikelnummer des Standardfittings mit dem Kurzzeichen des gewählten Einsatzwerkstoffes ergänzt, z.B. 720.1433-HC4

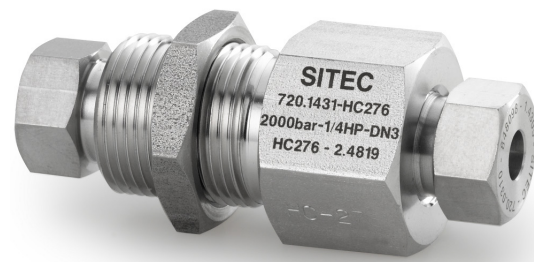

Raccords en matériaux résistants à la corrosion

- Raccords et adaptateurs haute pression avec le noyau en contact avec le fluid en matériaux résistants à la corrosion.
- Avec la construction frettée SITEC l'insert au matériau choisi assure la résistance à la corrosion tandis que le corps externe en Z6 CNDT 17.12 à haute résistance mécanique maintient la pression.
- Avec cette construction frettée même des matériaux très doux à haute résistance à la corrosion peuvent être appliqués sous hautes pressions.
- Matériaux des inserts de raccords:
Hastelloy C4 – Hastelloy C276 – Hastelloy C22 – Monel – titane – Inconel.
- Autres matériaux à la demande.
- Raccords en matériaux résistants à la corrosion selon les pages 720.01–720.06 du catalogue haute pression.
- Pour désigner les raccords en matériaux résistants à la corrosion, veuillez ajouter l'abréviation du matériau choisi à la référence du raccord standard, p. ex. 720.1433-HC4.

Fittings and Adapters in corrosion-resistant materials

- High-pressure fittings and adapters with all wetted parts in corrosion-resistant materials.
- With the reliable SITEC double wall design, the insert in the chosen material ensures corrosion resistance and the high-strength body in AISI 316Ti secures the pressure resistance of the unit.
- With this double wall design, relatively soft, but extremely corrosion-resistant materials may also be applied with high pressures.
- Available fitting insert materials:
Hastelloy C4 – Hastelloy C276 – Hastelloy C22 – Monel – titanium – Inconel.
- Other materials available on request.
- Fittings in corrosion-resistant materials are available according to the catalogue pages 720.01–720.06.
- To specify the corrosion-resistant fitting, the abbreviation of the chosen material is used as a suffix to the Part Number of the standard fitting, for example 720.1433-HC4.

Druck Pressure Pression	Rohr Tubing Tube	A Ø OD Ø ext.	DN Ø Orif. Pass.	Winkel Elbow Angle	T-Stück Tee Raccord T	Kreuzstück Cross Raccord croix	Verbinder Union Raccord droit	Art.-Nr. ergänzen mit Add to Part No. Ajouter à la Référence	
bar	inch	mm	mm	Art.-Nr. / Part No. / Référence					
1000	9/16	14.3	8.0	720.1312	720.1313	720.1314	720.1310	-HC4 -HC276 -Mo -Ti etc.	Hastelloy C4 Hastelloy C276 Monel Titan
	3/8	9.52	5.0	720.1322	720.1323	720.1324	720.1320		
2000	3/8	9.52	3.0	720.1422	720.1423	720.1424	720.1420		
	1/4	6.35	3.0	720.1432	720.1433	720.1434	720.1430		
	1/8	3.20	1.5	720.1402	720.1403	720.1404	720.1400		

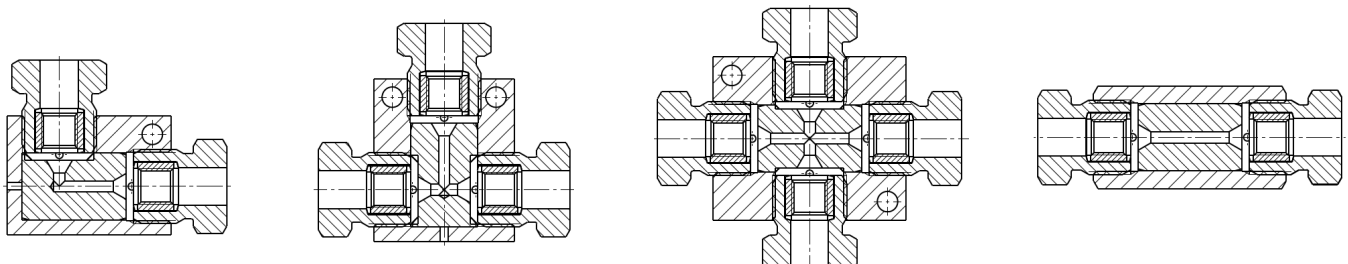

Reduzierungen – Reducers – Réducteurs

Werkstoff: 1.4571 – Material: AISI 316Ti

2000–7000 bar
29 000–104 500 PSI

Druck Pressure Pression	HP-Rohrverschraubungen HP tube connections Raccordements HP						DN Ø Orif. Pass.	Art.-Nr. Part No. Référence
	U		F	T		d		
bar	inch	mm		inch	mm	mm		
2000	11/16 HP	17.5	M30 × 2	9/16 HP	14.3	8	725.2211	
2000	11/16 HP	17.5	M30 × 2	3/8 HP	9.52	5	725.2221-M	
2000	11/16 HP	17.5	M30 × 2	1/4 HP	6.35	3	725.2231	
2000	11/16 HP	17.5	M30 × 2	1/8 HP	3.20	1.5	725.2201	
2000	9/16 HP	14.3	M26 × 1.5	11/16 HP	17.5	8	725.2121	
2000	9/16 HP	14.3	M26 × 1.5	3/8 HP	9.52	5	720.2121-D5	
4000	9/16 HP	14.3	M26 × 1.5	3/8 HP	9.52	3	720.2121	
4000	9/16 HP	14.3	M26 × 1.5	1/4 HP	6.35	3	720.2131	
4000	9/16 HP	14.3	M26 × 1.5	1/8 HP	3.20	1.5	720.2101	
2000	3/8 HP	9.52	M20 × 1.5	11/16 HP	17.5	3	725.2221-F	
2000	3/8 HP	9.52	M20 × 1.5	9/16 HP	14.3	5	720.2211-D5	
4000	3/8 HP	9.52	M20 × 1.5	9/16 HP	14.3	3	720.2211	
4000	3/8 HP	9.52	M20 × 1.5	1/4 HP	6.35	3	720.2231	
4000	3/8 HP	9.52	M20 × 1.5	1/8 HP	3.20	1.5	720.2201	
2000	1/4 HP	6.35	M16 × 1.5	11/16 HP	17.5	3	725.2321	
4000	1/4 HP	6.35	M16 × 1.5	9/16 HP	14.3	3	720.2311	
4000	1/4 HP	6.35	M16 × 1.5	3/8 HP	9.52	3	720.2321	
4000	1/4 HP	6.35	M16 × 1.5	1/8 HP	3.20	1.5	720.2301	
2000	11/16 HP	17.5	M30 × 2	9/16 HP	14.3	8	725.2210	
2000	11/16 HP	17.5	M30 × 2	3/8 HP	9.52	5	725.2220	
2000	11/16 HP	17.5	M30 × 2	1/4 HP	6.35	3	725.2230	
2000	11/16 HP	17.5	M30 × 2	1/8 HP	3.20	1.5	725.2200	
2000	9/16 HP	14.3	M26 × 1.5	3/8 HP	9.52	5	720.2120-D5	
2000	9/16 HP	14.3	M26 × 1.5	3/8 HP	9.52	3	720.2120	
4000	9/16 HP	14.3	M26 × 1.5	1/4 HP	6.35	3	720.2130	
4000	9/16 HP	14.3	M26 × 1.5	1/8 HP	3.20	1.5	720.2100	
4000	3/8 HP	9.52	M20 × 1.5	1/4 HP	6.35	3	720.2230	
4000	3/8 HP	9.52	M20 × 1.5	1/8 HP	3.20	1.5	720.2200	
4000	1/4 HP	6.35	M16 × 1.5	1/8 HP	3.20	1.5	720.2300	

HP – HP

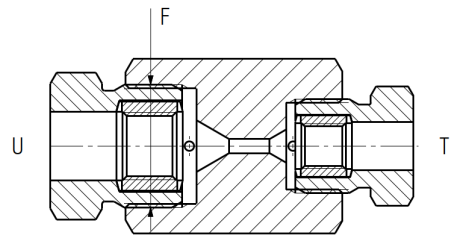
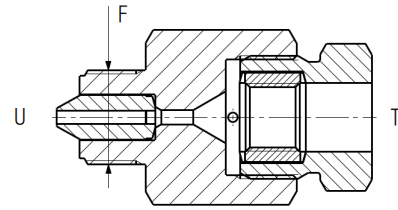

Druck Pressure Pression	HP-Rohrverschraubungen HP tube connections Raccordements HP						DN Ø Orif. Pass.	Art.-Nr. Part No. Référence
	U		F	T		d		
bar	inch	mm		inch	mm	mm		
2000	11/16 HP	17.5	M30 × 2			12	725.2227	
2000	9/16 HP	14.3	M26 × 1.5			8	720.2226	
4000	9/16 HP	14.3	M26 × 1.5			5	720.2225	
4000	3/8 HP	9.52	M20 × 1.5			3	720.2224	
4000	3/8 HP	9.52	M20 × 1.5			3	720.2223	
7000	1/4 HP	6.35	M16 × 1.5			1.6	720.2222	
4000	1/4 HP	6.35	M16 × 1.5			3	720.2221	
4000	1/8 HP	3.20	M16 × 1.5			1.5	720.2220	
2000			M30 × 2	11/16 HP	17.5	12	725.2117	
4000			M26 × 1.5	9/16 HP	14.3	5	720.2116	
4000			M20 × 1.5	3/8 HP	9.52	3	720.2114	
7000			M16 × 1.5	1/4 HP	6.35	1.6	720.2112	
4000			M16 × 1.5	1/4 HP	6.35	1.6	720.2111	
4000			M16 × 1.5	1/8 HP	3.20	1.5	720.2110	
10000			M20 × 1.5	3/8 UHP	9.52	1.6	720.2117	

Blanks

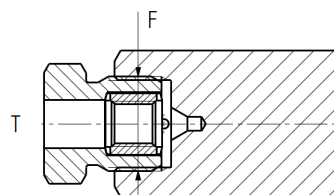
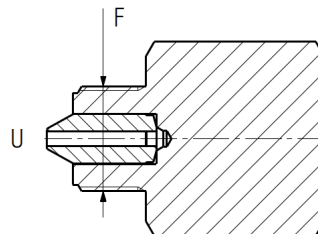

Übergangsstücke – Adapters – Adaptateurs

1000–1500 bar

Werkstoff: 1.4571 – Material: AISI 316Ti

14 500–21 750 PSI

Druck Pressure Pression	HP-Rohrverschraubungen HP tube connections Raccordements HP		ND-Anschluss Low pressure Basse pression	DN Ø Orif. Pass.	Art.-Nr. Part No. Référence	
	T inch mm	F				G d mm
1500	11/16 HP	17.5	M30 × 2	1/2" NPT	8	725.2241
1500	11/16 HP	17.5	M30 × 2	3/8" NPT	5	725.2251
1500	11/16 HP	17.5	M30 × 2	1/4" NPT	3	725.2261
1500	9/16 HP	14.3	M26 × 1.5	1/2" NPT	8	720.2141
1500	9/16 HP	14.3	M26 × 1.5	3/8" NPT	5	720.2151
1500	9/16 HP	14.3	M26 × 1.5	1/4" NPT	3	720.2161
1500	3/8 HP	9.52	M20 × 1.5	1/2" NPT	3	720.2241
1500	3/8 HP	9.52	M20 × 1.5	3/8" NPT	3	720.2251
1500	3/8 HP	9.52	M20 × 1.5	1/4" NPT	3	720.2261
1500	1/4 HP	6.35	M16 × 1.5	1/2" NPT	3	720.2341
1500	1/4 HP	6.35	M16 × 1.5	3/8" NPT	3	720.2351
1500	1/4 HP	6.35	M16 × 1.5	1/4" NPT	3	720.2361
1500	1/8 HP	3.20	M16 × 1.5	1/4" NPT	1.5	720.2061
1500	11/16 HP	17.5	M30 × 2	G 1/2"	8	725.2271
1500	11/16 HP	17.5	M30 × 2	G 3/8"	5	725.2281
1500	11/16 HP	17.5	M30 × 2	G 1/4"	3	725.2291
1400	9/16 HP	14.3	M26 × 1.5	G 1/2"	8	720.2171
1500	9/16 HP	14.3	M26 × 1.5	G 3/8"	5	720.2181
1500	9/16 HP	14.3	M26 × 1.5	G 1/4"	3	720.2191
1400	3/8 HP	9.52	M20 × 1.5	G 1/2"	3	720.2271
1500	3/8 HP	9.52	M20 × 1.5	G 3/8"	3	720.2281
1500	3/8 HP	9.52	M20 × 1.5	G 1/4"	3	720.2291
1400	1/4 HP	6.35	M16 × 1.5	G 1/2"	3	720.2371
1500	1/4 HP	6.35	M16 × 1.5	G 3/8"	3	720.2381
1500	1/4 HP	6.35	M16 × 1.5	G 1/4"	3	720.2391
1500	1/4 HP	6.35	M16 × 1.5	G 1/8"	3	720.2391-G1-8
1500	1/8 HP	3.20	M16 × 1.5	G 1/4"	1.5	720.2091

- HP weiblich - NPT + G(Gas) männlich
- HP female - NPT + BSP male
- HP femelle - NPT + gaz mâle

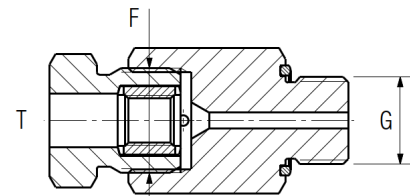

* Dichtring – Seal – Joint		
Für G	1/2"	791.26.0014-10
For BSP	3/8"	791.26.0012-10
Pour gaz	1/4"	791.26.0004-10

bar	inch	mm			mm	
1500	11/16 HP	17.5	M30 × 2	1/2" NPT	8	725.2240
1500	11/16 HP	17.5	M30 × 2	3/8" NPT	5	725.2250
1500	11/16 HP	17.5	M30 × 2	1/4" NPT	3	725.2260
1500	9/16 HP	14.3	M26 × 1.5	1/2" NPT	8	720.2140
1500	9/16 HP	14.3	M26 × 1.5	3/8" NPT	5	720.2150
1500	9/16 HP	14.3	M26 × 1.5	1/4" NPT	3	720.2160
1500	3/8 HP	9.52	M20 × 1.5	1/2" NPT	3	720.2240
1500	3/8 HP	9.52	M20 × 1.5	3/8" NPT	3	720.2250
1500	3/8 HP	9.52	M20 × 1.5	1/4" NPT	3	720.2260
1500	1/4 HP	6.35	M16 × 1.5	1/2" NPT	3	720.2340
1500	1/4 HP	6.35	M16 × 1.5	3/8" NPT	3	720.2350
1500	1/4 HP	6.35	M16 × 1.5	1/4" NPT	3	720.2360
1500	1/8 HP	3.20	M16 × 1.5	1/8" NPT	1.5	720.2060
1500	11/16 HP	17.5	M30 × 2	G 1/2"	8	725.2270
1500	11/16 HP	17.5	M30 × 2	G 3/8"	5	725.2280
1500	11/16 HP	17.5	M30 × 2	G 1/4"	3	725.2290
1400	9/16 HP	14.3	M26 × 1.5	G 1/2"	8	720.2170
1500	9/16 HP	14.3	M26 × 1.5	G 3/8"	5	720.2180
1500	9/16 HP	14.3	M26 × 1.5	G 1/4"	3	720.2190
1400	3/8 HP	9.52	M20 × 1.5	G 1/2"	3	720.2270
1500	3/8 HP	9.52	M20 × 1.5	G 3/8"	3	720.2280
1500	3/8 HP	9.52	M20 × 1.5	G 1/4"	3	720.2290
1400	1/4 HP	6.35	M16 × 1.5	G 1/2"	3	720.2370
1500	1/4 HP	6.35	M16 × 1.5	G 3/8"	3	720.2380
1500	1/4 HP	6.35	M16 × 1.5	G 1/4"	3	720.2390
1400	1/8 HP	3.20		G 1/2"	1.5	720.2070

- HP weiblich - NPT + G(Gas) weiblich
- HP female - NPT + BSP female
- HP femelle - NPT + gaz femelle

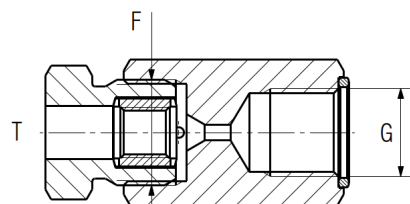

* Dichtring – Seal – Joint		
Für G	1/2"	791.26.0014-10
For BSP	3/8"	791.26.0012-10
Pour gaz	1/4"	791.26.0004-10

Übergangsstücke – Adapters – Adaptateurs

Werkstoff: 1.4571 – Material: AISI 316Ti

1000–1500 bar
14 500–21 750 PSI

Druck Pressure Pression	HP-Rohrverschraubungen HP tube connections Raccordements HP		ND-Anschluss Low pressure Basse pression	DN Ø Orif. Pass.	Art.-Nr. Part No. Référence	
	T inch mm	F				
1500	11/16 HP	17.5	M30 × 2	1/2" NPT	8	725.2421
1500	11/16 HP	17.5	M30 × 2	3/8" NPT	5	725.2521
1500	11/16 HP	17.5	M30 × 2	1/4" NPT	3	725.2621
1500	9/16 HP	14.3	M26 × 1.5	1/2" NPT	8	720.2411
1500	9/16 HP	14.3	M26 × 1.5	3/8" NPT	5	720.2511
1500	9/16 HP	14.3	M26 × 1.5	1/4" NPT	3	720.2611
1500	3/8 HP	9.52	M20 × 1.5	1/2" NPT	3	720.2421
1500	3/8 HP	9.52	M20 × 1.5	3/8" NPT	3	720.2521
1500	3/8 HP	9.52	M20 × 1.5	1/4" NPT	3	720.2621
1500	1/4 HP	6.35	M16 × 1.5	1/2" NPT	3	720.2431
1500	1/4 HP	6.35	M16 × 1.5	3/8" NPT	3	720.2531
1500	1/4 HP	6.35	M16 × 1.5	1/4" NPT	3	720.2631
1500	11/16 HP	17.5	M30 × 2	G 1/2"	8	725.2721
1500	11/16 HP	17.5	M30 × 2	G 3/8"	5	725.2821
1500	11/16 HP	17.5	M30 × 2	G 1/4"	3	725.2921
1400	9/16 HP	14.3	M26 × 1.5	G 1/2"	8	720.2711
1500	9/16 HP	14.3	M26 × 1.5	G 3/8"	5	720.2811
1500	9/16 HP	14.3	M26 × 1.5	G 1/4"	3	720.2911
1400	3/8 HP	9.52	M20 × 1.5	G 1/2"	3	720.2721
1500	3/8 HP	9.52	M20 × 1.5	G 3/8"	3	720.2821
1500	3/8 HP	9.52	M20 × 1.5	G 1/4"	3	720.2921
1400	1/4 HP	6.35	M16 × 1.5	G 1/2"	3	720.2731
1500	1/4 HP	6.35	M16 × 1.5	G 3/8"	3	720.2831
1500	1/4 HP	6.35	M16 × 1.5	G 1/4"	3	720.2931
1500	1/8 HP	3.20	M16 × 1.5	G 1/4"	1.5	720.2901

HP männlich – NPT + G(Gas) weiblich
 HP male – NPT + BSP female
 HP mâle – NPT + gaz femelle

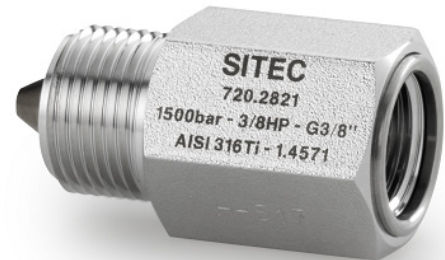
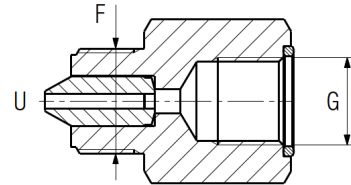

* Dichtring – Seal – Joint

Für G	1/2"	791.26.0014-10
For BSP	3/8"	791.26.0012-10
Pour gaz	1/4"	791.26.0004-10

Anschlussstücke – Connectors – Raccords

Werkstoff: 1.4571 – Material: AISI 316Ti

max. 7000 bar
max. 101 500 PSI

Manometeranschlüsse – Gauge connectors – Raccords de manomètre

Druck Pressure Pression	G	HP-Anschluss – HP tube connection – Raccord HP		
		1/4 HP 6.35mm M16 × 1.5	3/8 HP 9.52mm M20 × 1.5	9/16 HP 14.3mm M26 × 1.5
2500 bar	G 1/4"	720.3131	720.3421	720.3411
2500 bar	G 3/8"	720.3432		
2500 bar	G 1/2"	720.3433	720.3423	720.3413
4000 bar	G 3/4"	720.3634	720.3624	
7000 bar	G 1"	720.3835	720.3825	

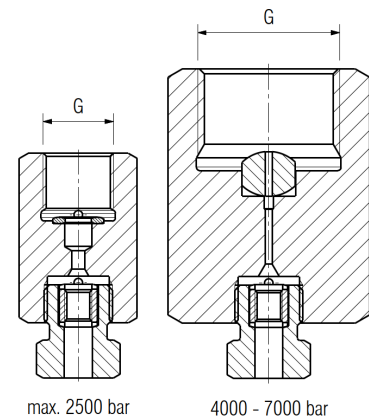

Gasflaschenanschlüsse – Gas bottle connectors – Raccords bouteilles gaz

CO ₂ , He, Ar	W21,8 – 14 RH	1/4 HP – M16 × 1.5	729.9131
N ₂ etc.	W24,3 – 14 RH	1/4 HP – M16 × 1.5	729.9131
Methan, H ₂	W21,8 – 14 LH	1/4 HP – M16 × 1.5	729.9131
O ₂	G 3/4" RH	1/4 HP – M16 × 1.5	729.9131

Messanschlüsse für Manometer und Druckaufnehmer – Connections for gauges and pressure transducers – Raccords pour manomètres et capteurs de pression

Druck Pressure Pression	HP-Verschraubungen HP connections Raccordements HP		Art.-Nr. Part No. Référence
	P	T	
2000	11/16 HP	1/4 HP	727.4340-d12/3
2000	9/16 HP	3/8 HP	727.1210-d8/5
4000	9/16 HP	3/8 HP	727.1210-d5/3
2000	9/16 HP	1/4 HP	727.1310-d8/3
4000	9/16 HP	1/4 HP	727.1310-d5/3
2000	3/8 HP	1/4 HP	727.2320-d5/3

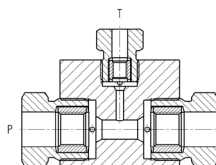

P	G	Art.-Nr. Part No. Référence
9/16 HP	G 1/2"	727.1710
3/8 HP	G 1/2"	727.2720
3/8 HP	G 1/4"	727.2920
1/4 HP	G 1/2"	727.3730
1/4 HP	G 3/8"	727.3830
1/4 HP	G 1/4"	727.3930

